

**[URBAN] CORRIDORS
KVILLEBÄCKEN**

YIFEI XU
CREATING EXTENSION
AUSD
2023



CONTENT

SITE ANALYSIS	3-4
COOGLE DIGRAM.....	5
PROTOTYPE DESIGN.....	6-9
PHOTOS OF MODEL.....	10
SYSTEM GROWTH.....	11
EVOLUTIONARY TREE.....	12
SWOT ANALYSIS.....	13



GROUP TRANSECT

Benjamin, Mika, Yifei | Kvillebäcks-Ending | ACE465 | 2023-11-13

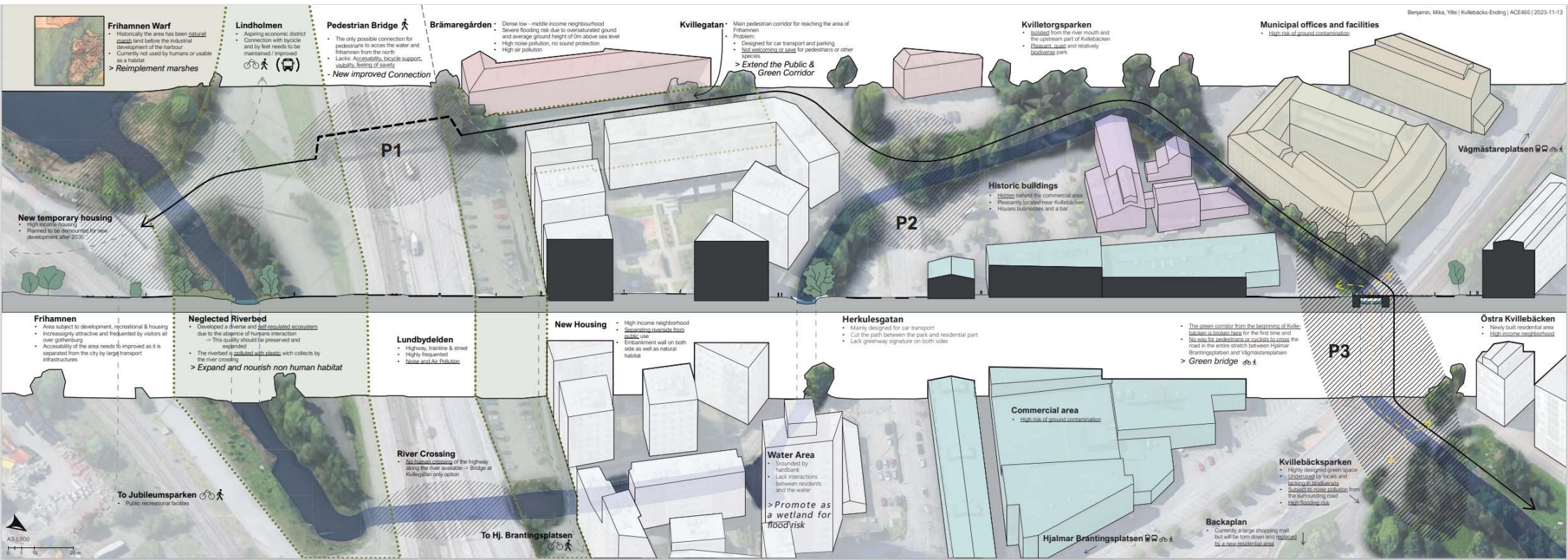

SITE

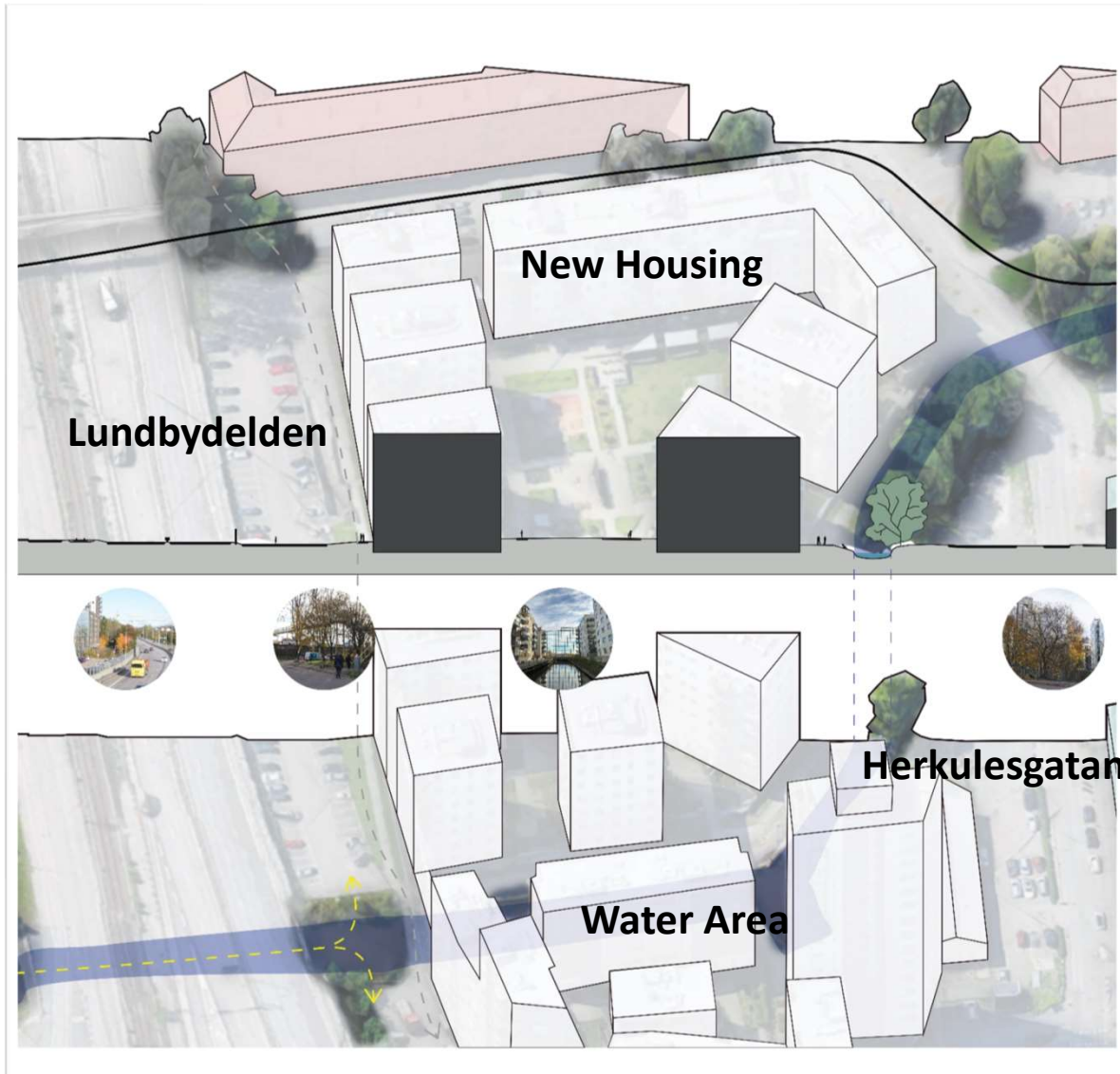

Feature

- Located in a high income neighborhood
- Separating riverside from public use
- Embankment wall on both side as well as natural habitat

To consider

- The incoherent relationship between water and the riverbank.
- Disruption of green corridor.
- Loss of nature life

PLAN&SECTION

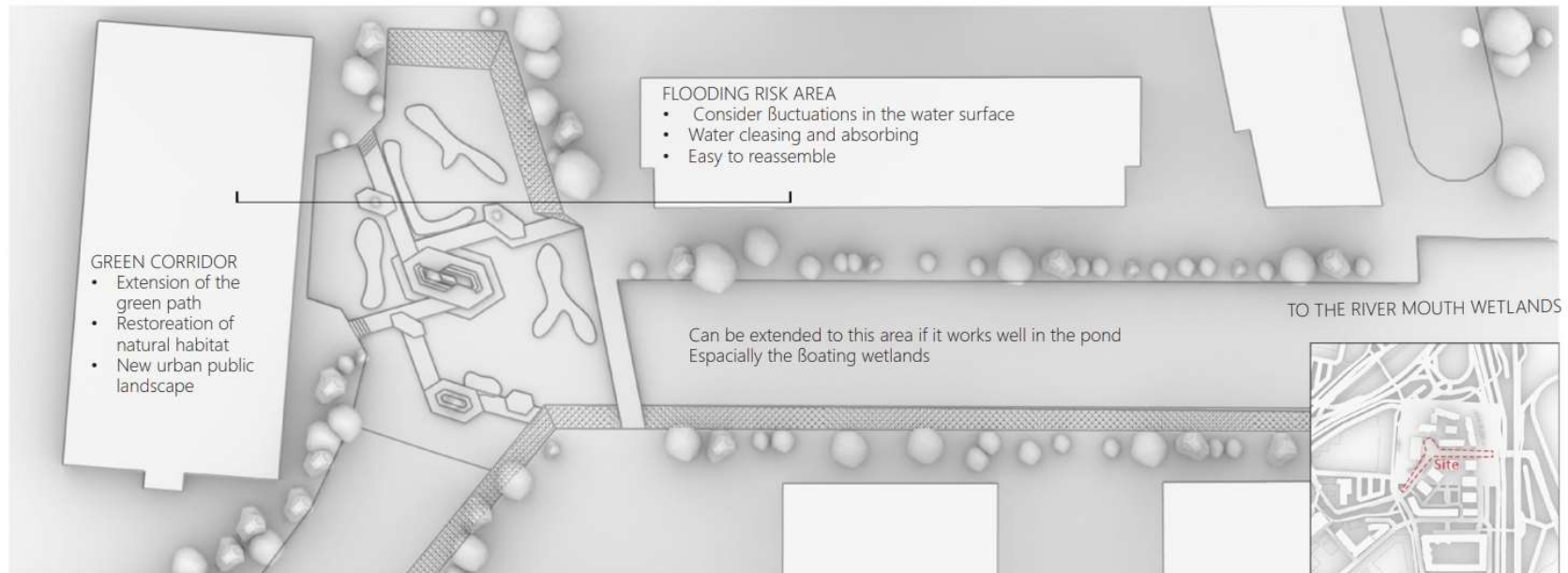

PERSPECTIVE

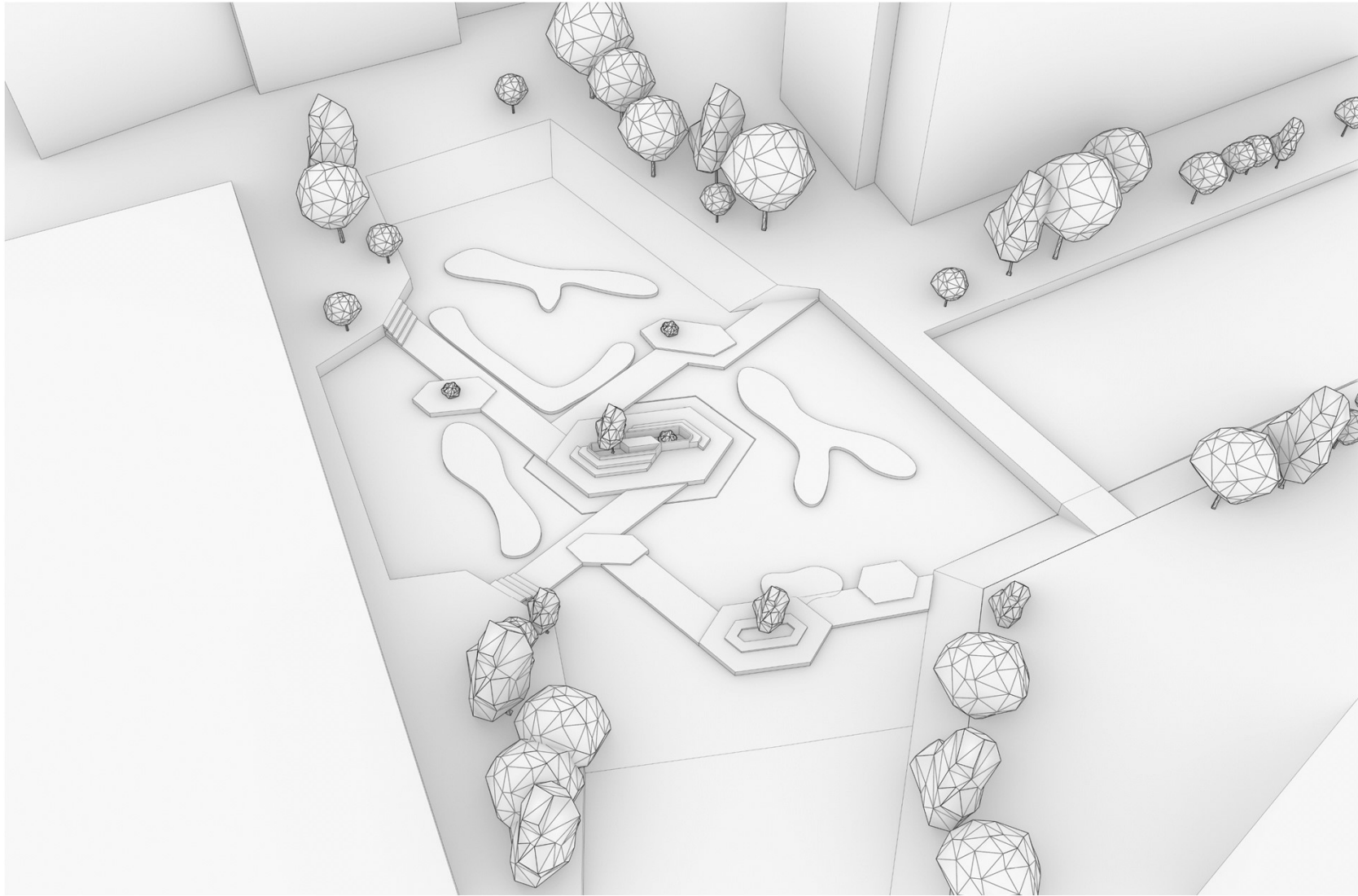

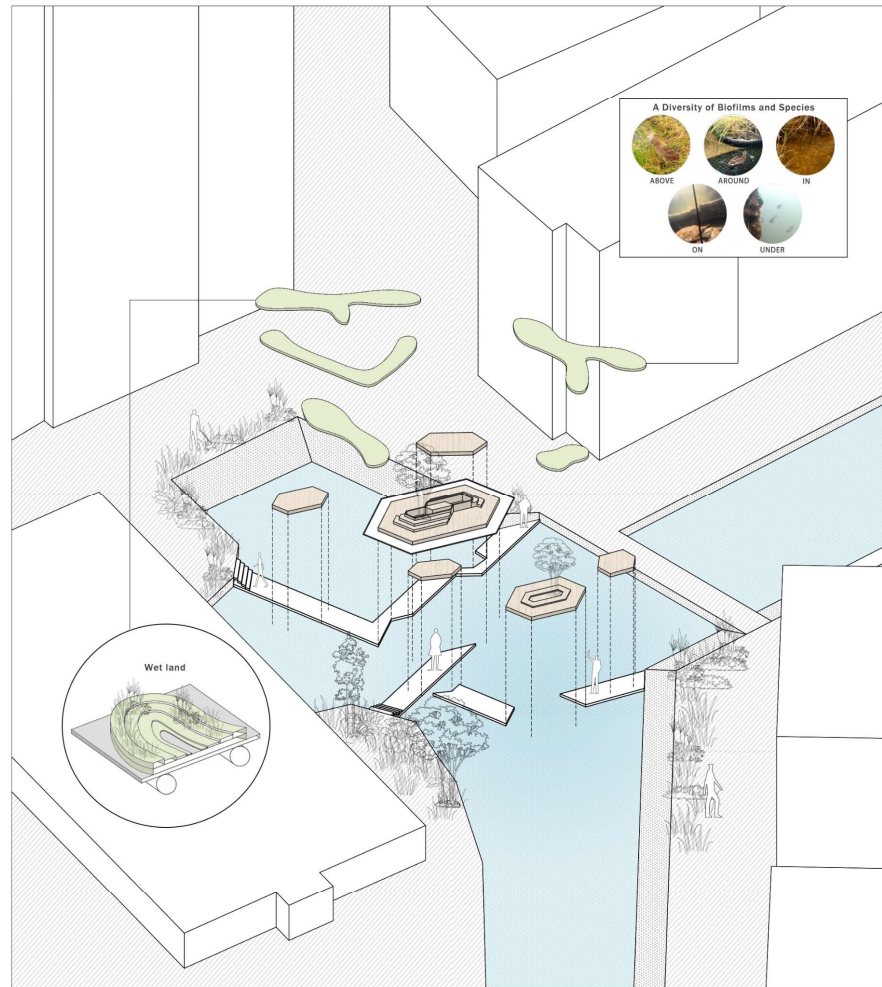

CONNECTION

- Covered with green vegetation and full of natural forms
- Provide a public place for social gathering

CLEANSING

- Floating versions provide a range of ecosystem services just like natural wetlands
- Anchored the floating wetlands to the river



Prototype in Baltimore. NATIONAL AQUARIUM

SECTION

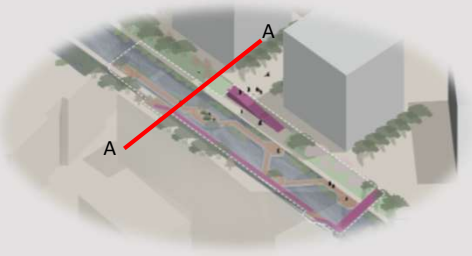
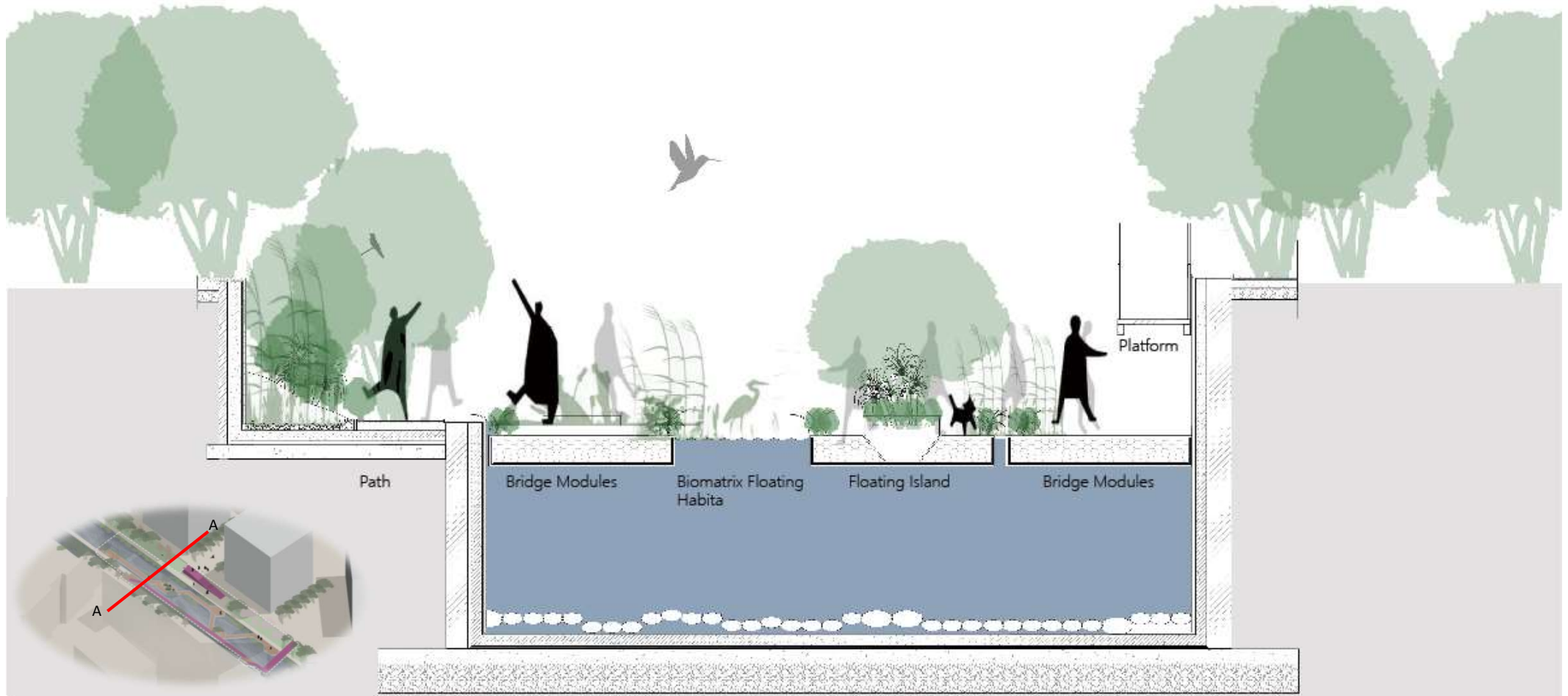

1:50

MODEL

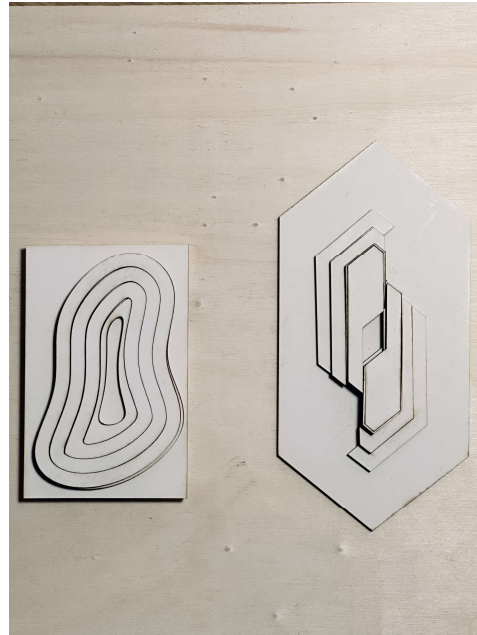

GROTH

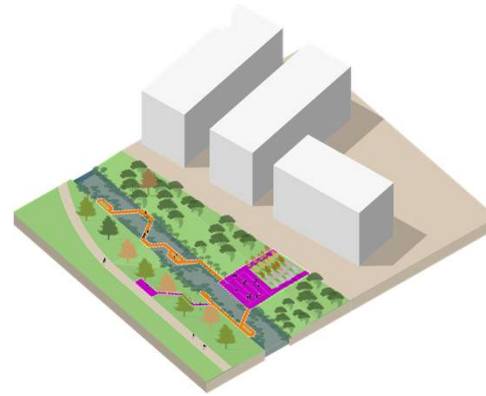

- Composed of soft river bank
- Considering the connection and gathering
- Provide more route options

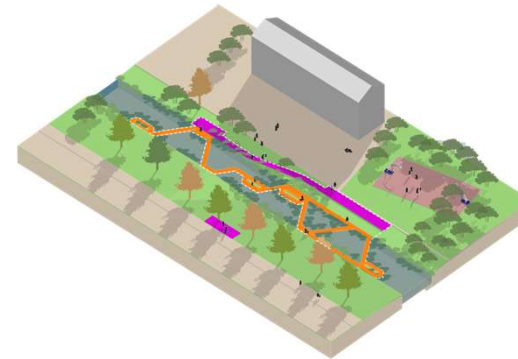

- Composed of both soft and hard river bank
- Add platform on the parking-lot side
- Maintain the quiet atmosphere

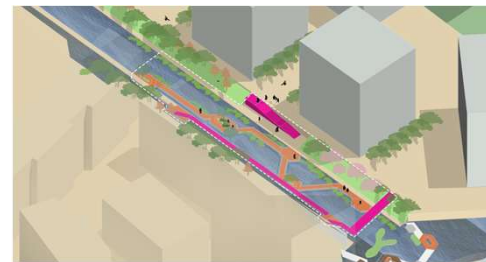

- Composed of mainly hard river bank
- Connection, cleaning and gathering
- Platforms are needed

EVOLUTIONARY TREE



miro

SWOT ANALYSIS

