

Index

1.....	Index
2.....	River transect plan and section
3.....	Coggle diagram
4....	Pavilion plans, sections and facades
7....	Plan and section analysis drawings
8.....	Axonometric perspective drawings
10.....	Project evolutionary tree
12.....	Technical perspective section
14.	Potential multiplication of prototype

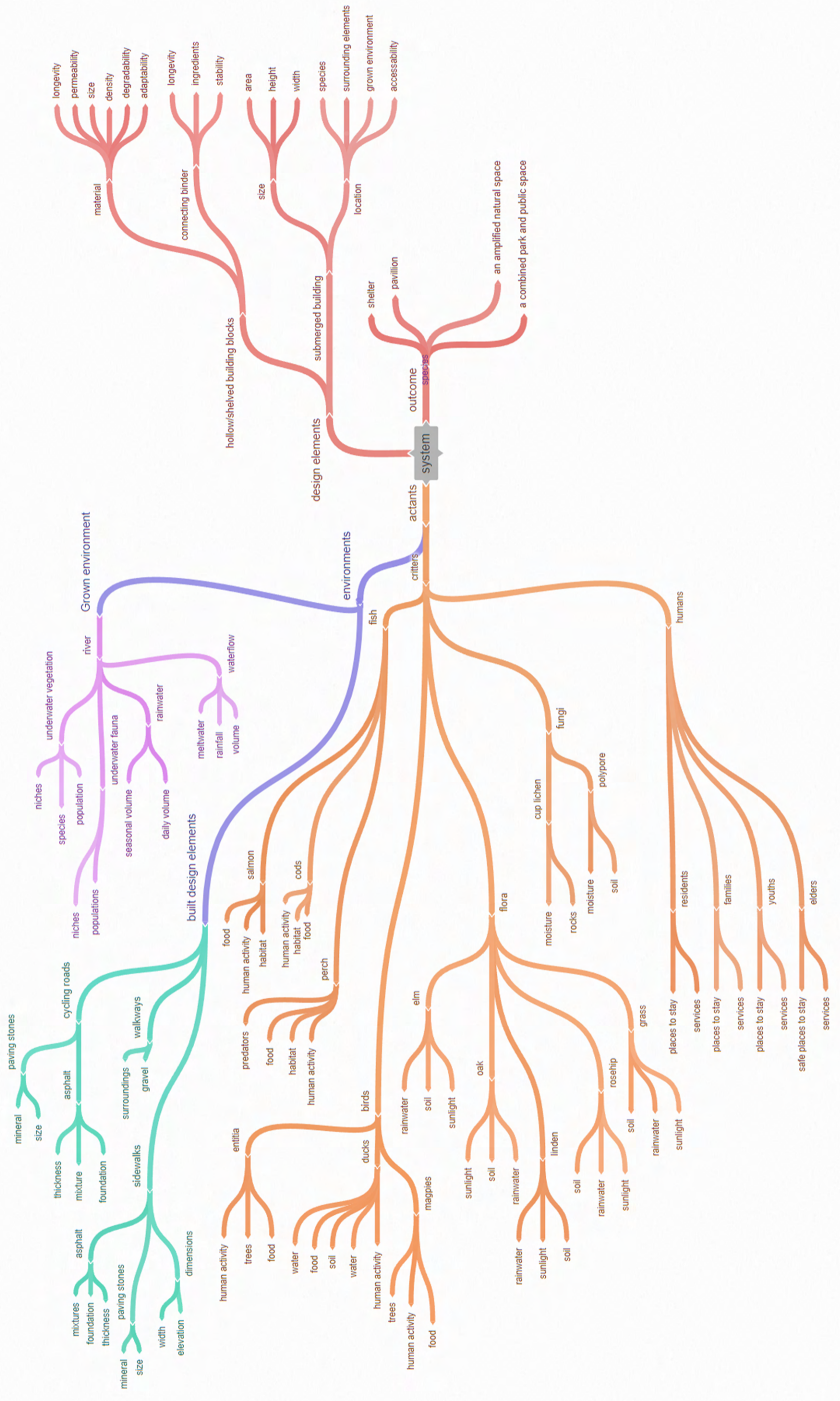



Shelf cell pavilion

Plan with roof
1:100

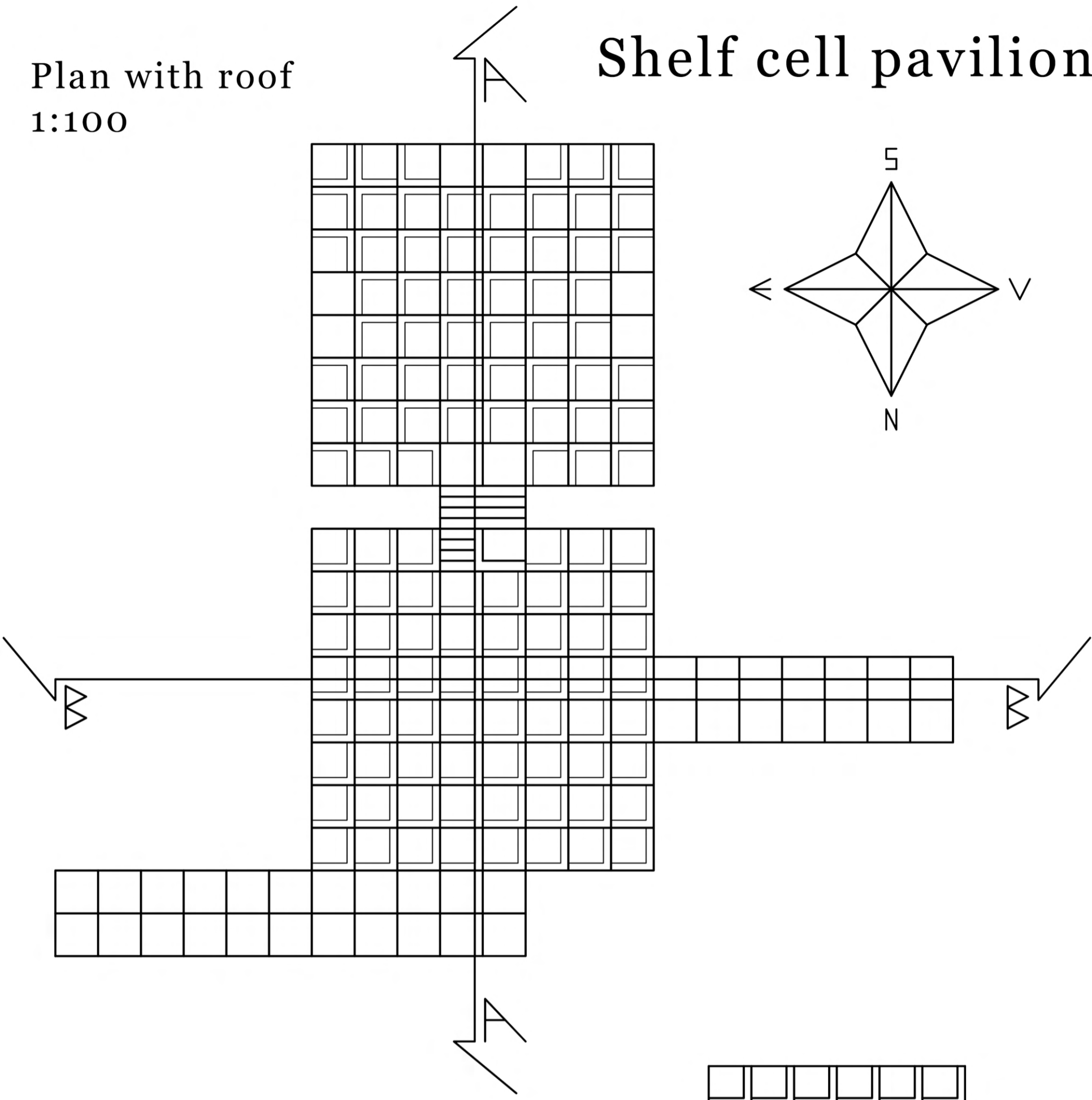

Section A-A
1:100

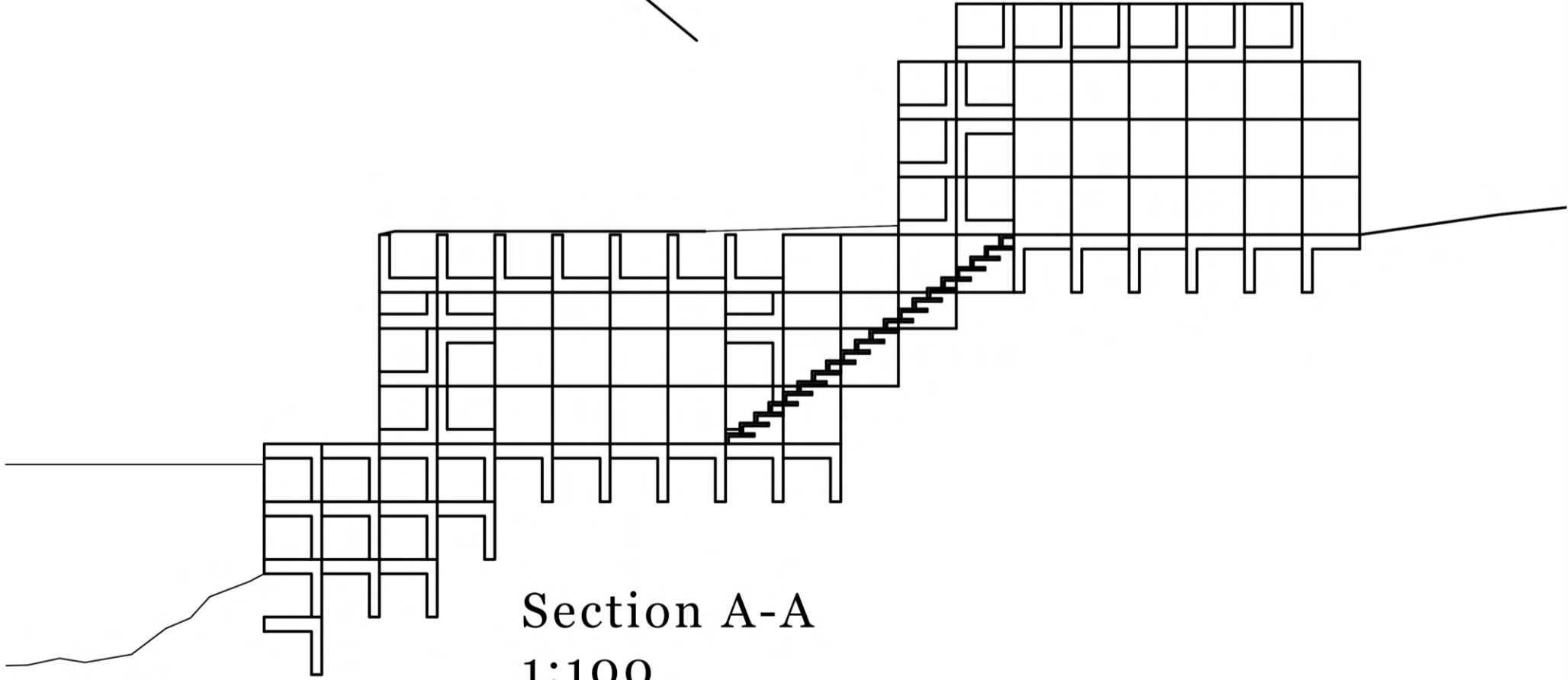

Plan without roof
1:100

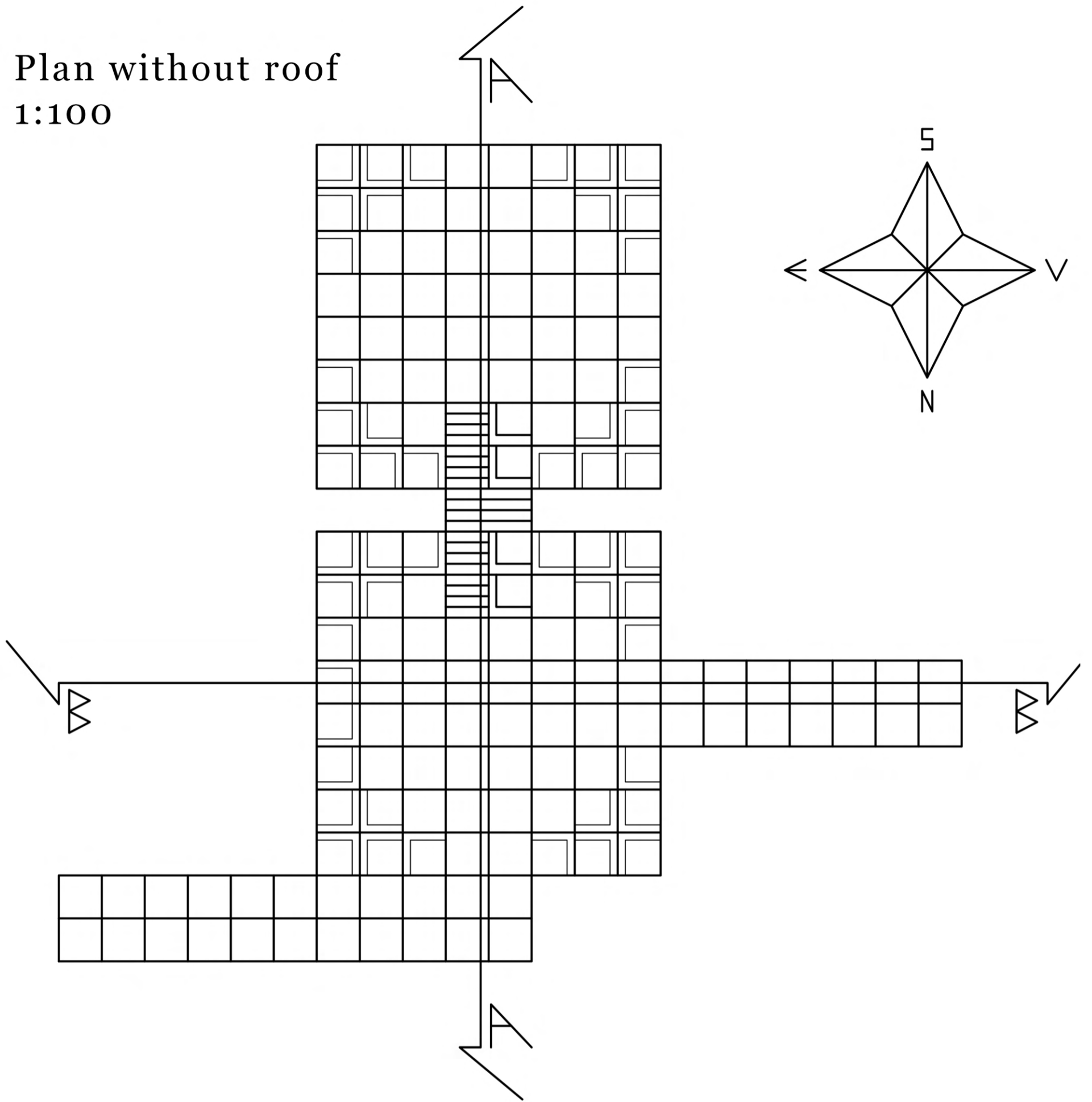

Section B-B
1:100

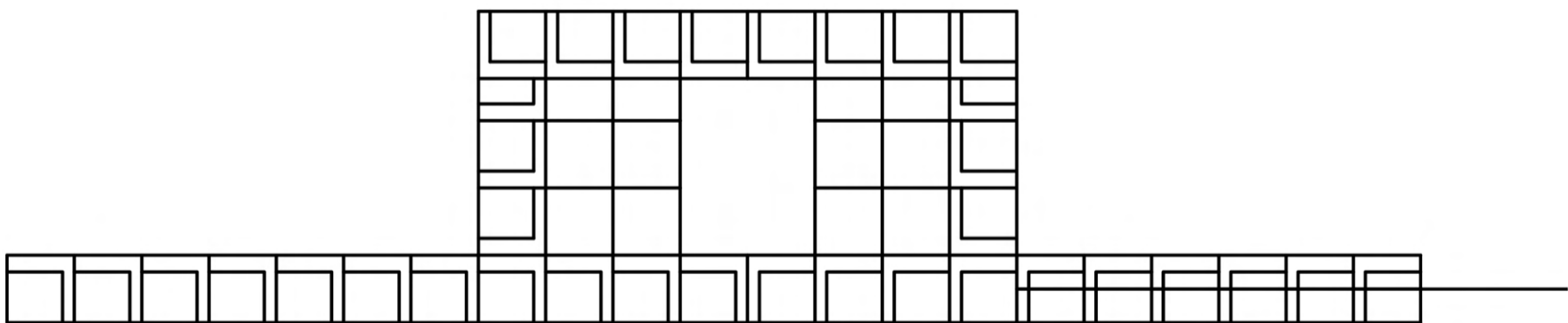

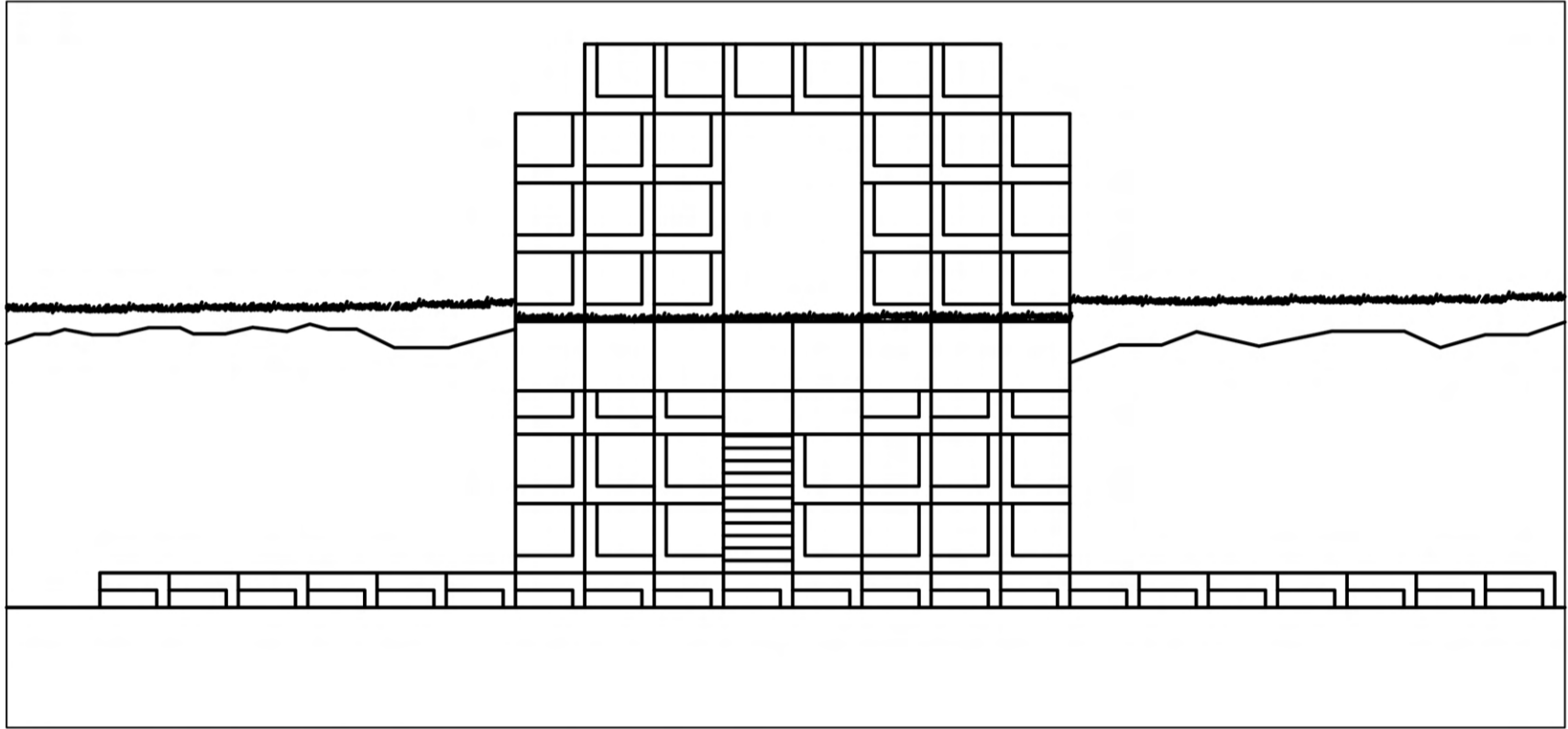

Facade to the north 1:100

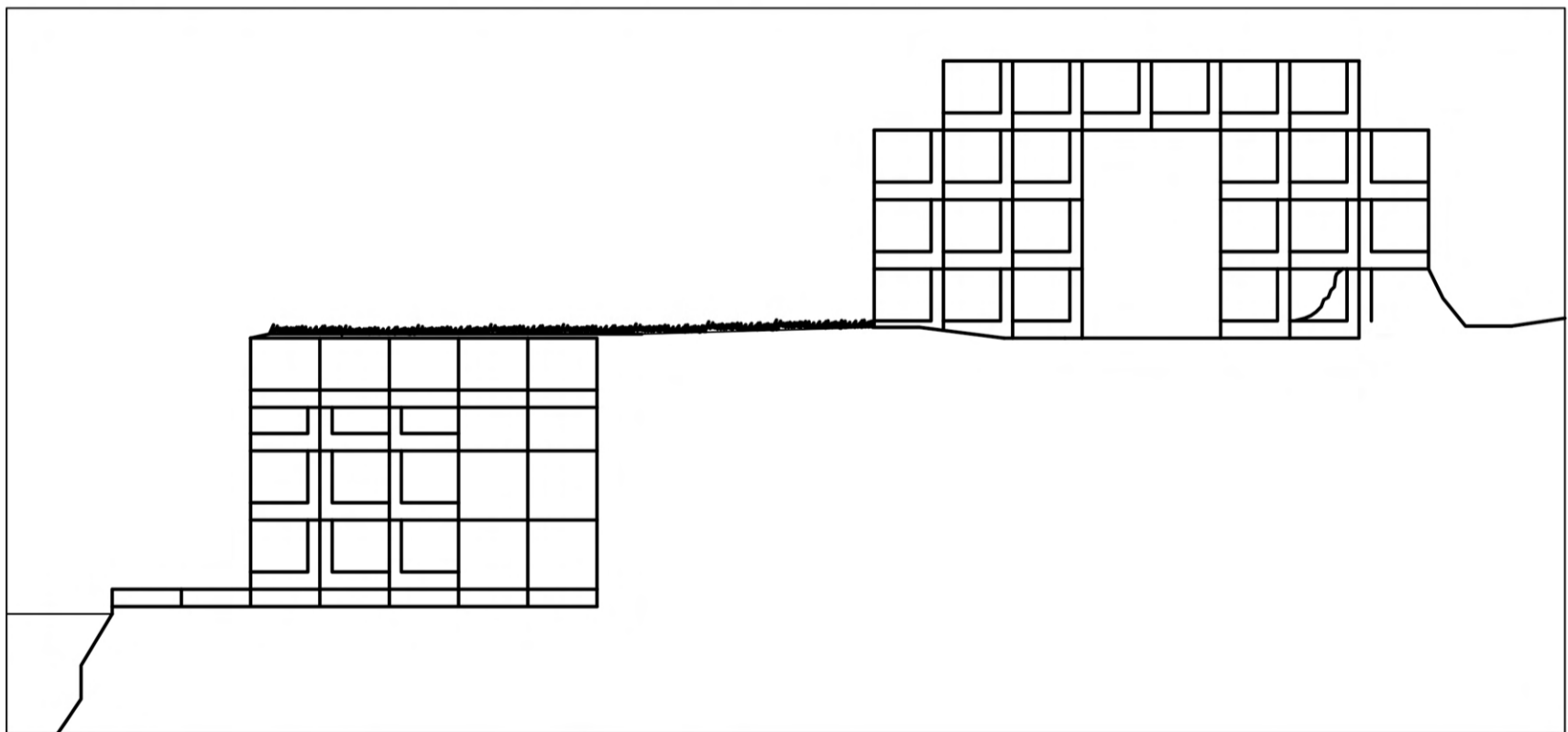

Facade to the west 1:100

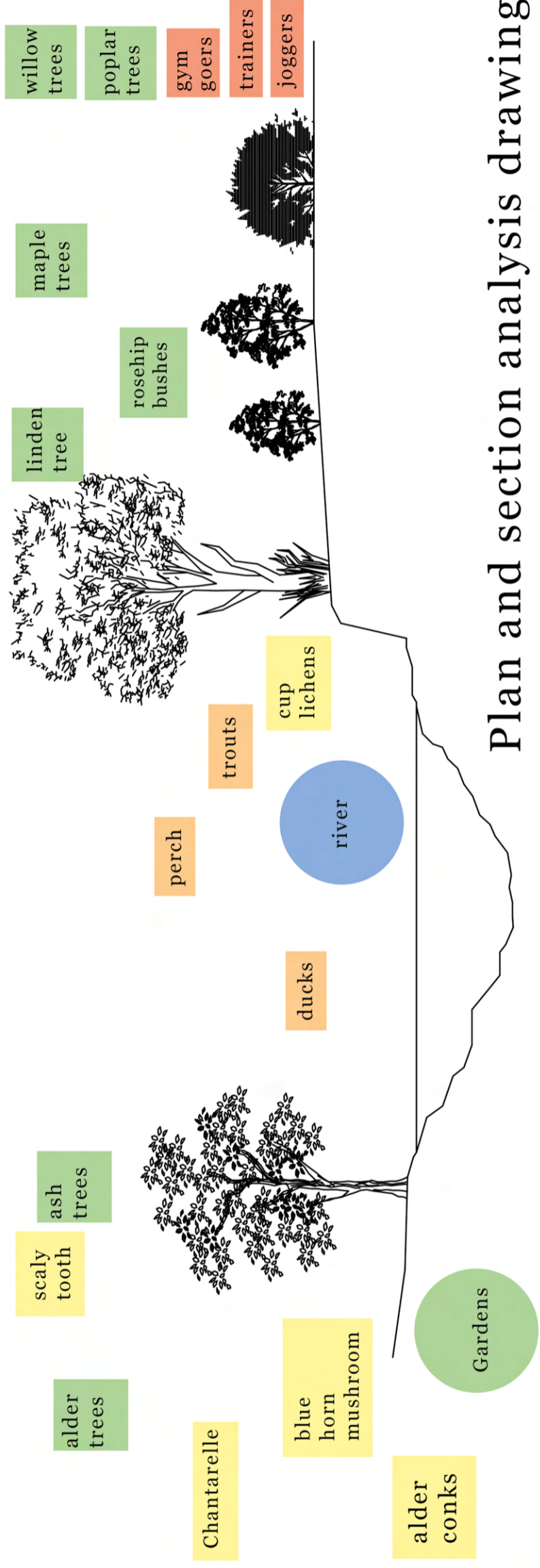

Plan and section analysis drawings

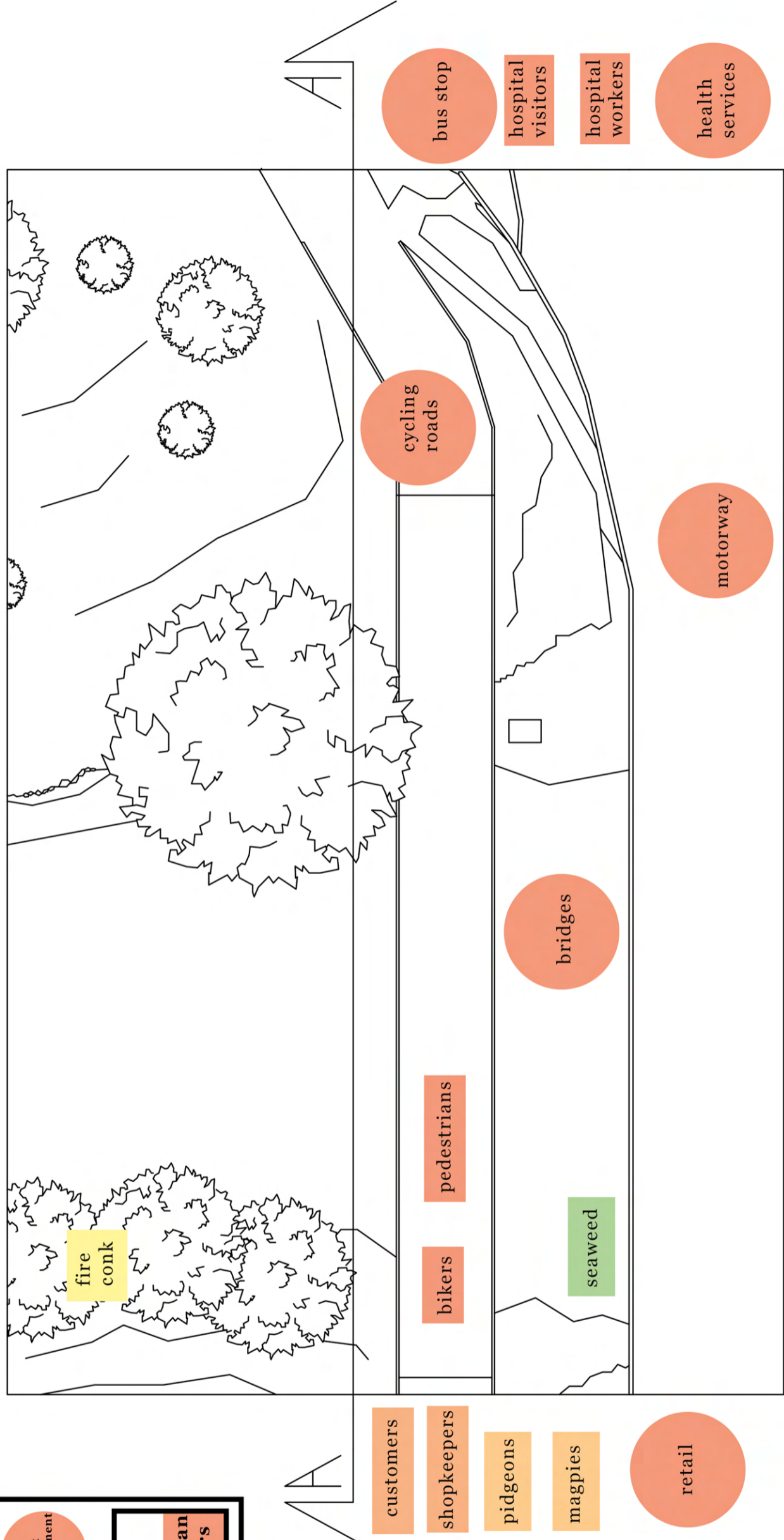
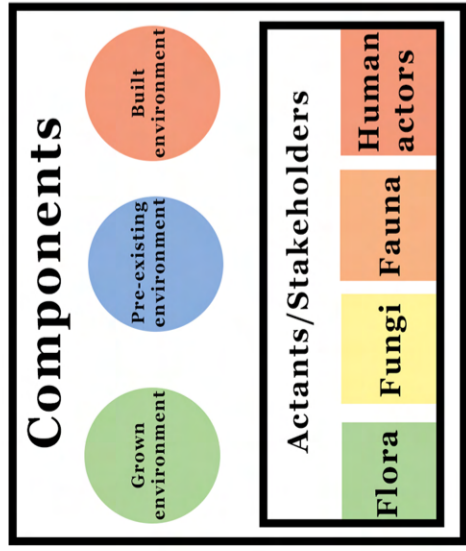

Shelf cell pavilion

Axonometric perspectives removed from the ground

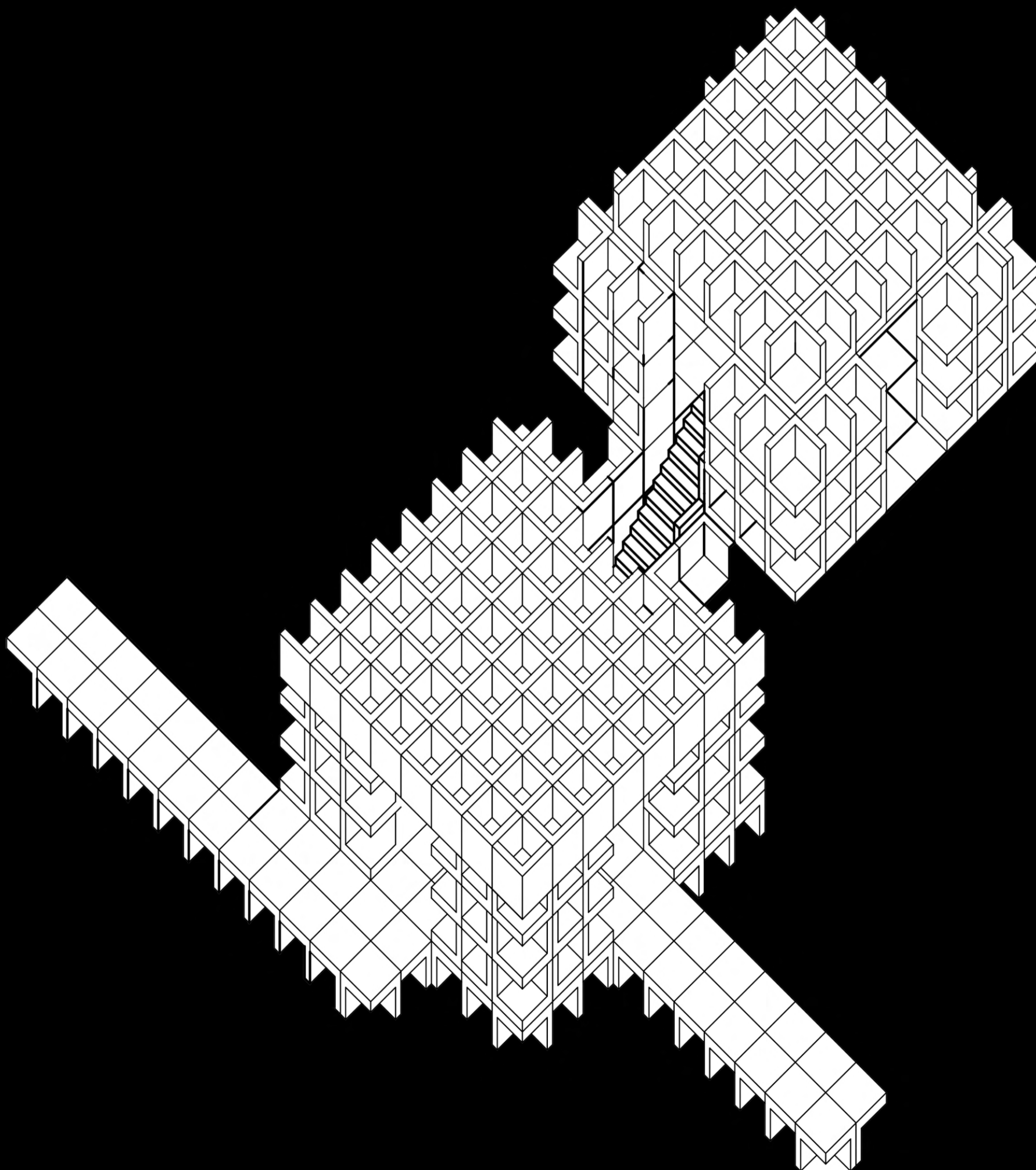

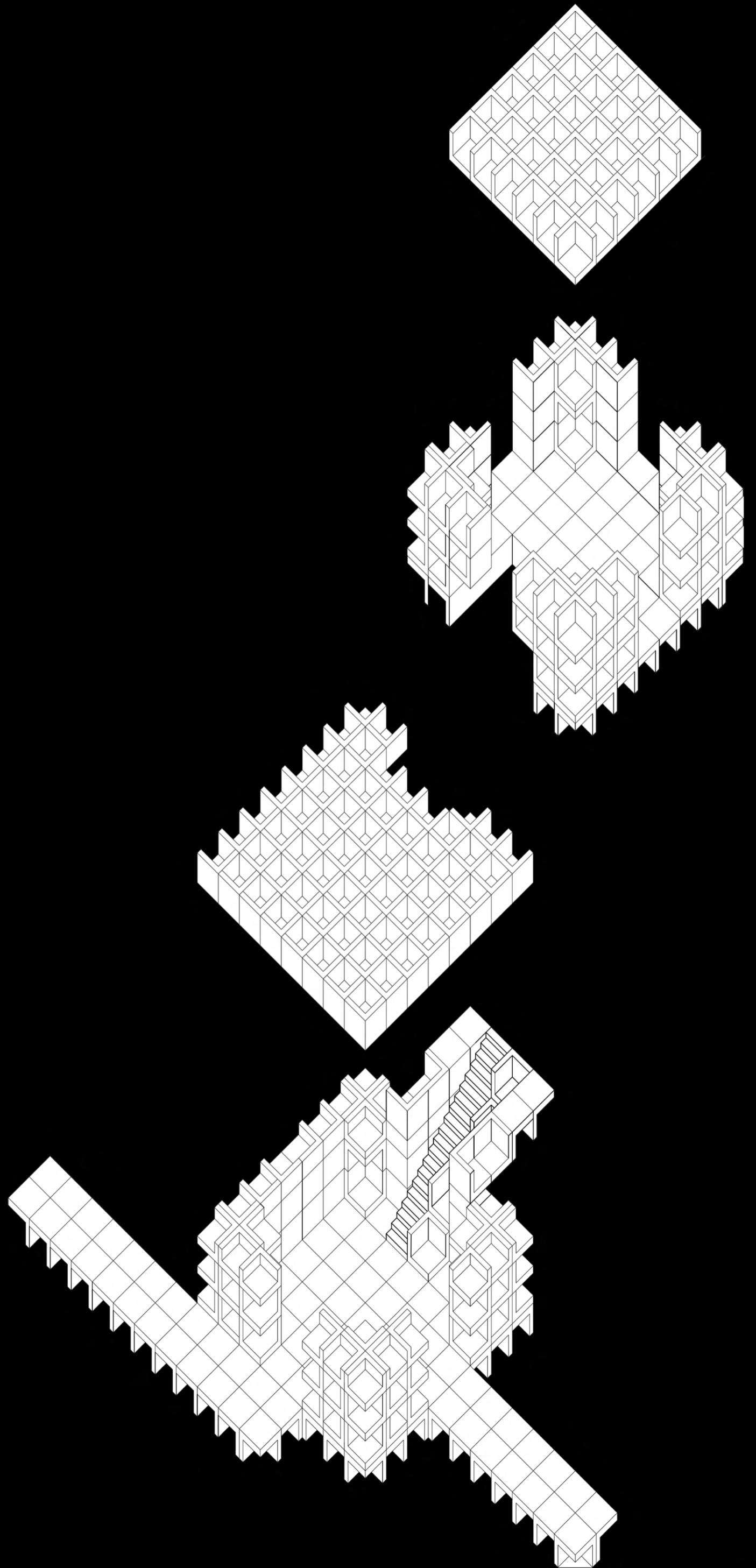

The goal from the beginning was to use a type of hollow building blocks in order to increase a building's surface to the environment.

I decided on making them like shelves.

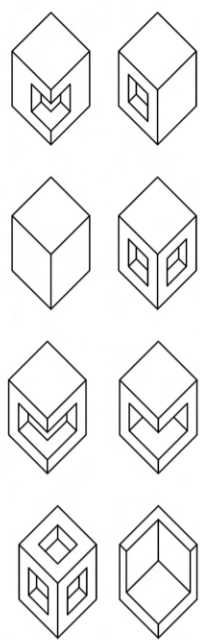

Shelf cell pavilion

Project evolutionary tree

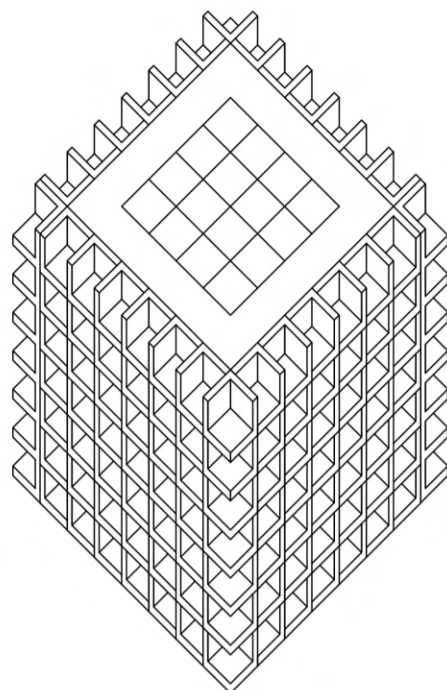

When playing around with the building cells I initially imagined a multi-story-building with a slanted roof.

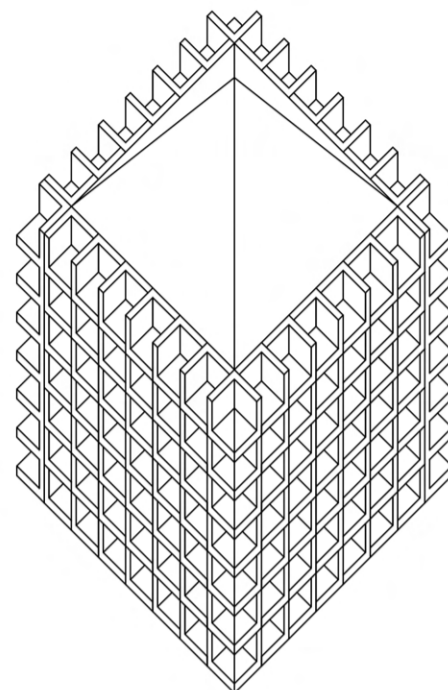

Later when the area was more specified, a smaller pavilion was more fitting and I looked into ways of making it inviting, with multiple entrance points.

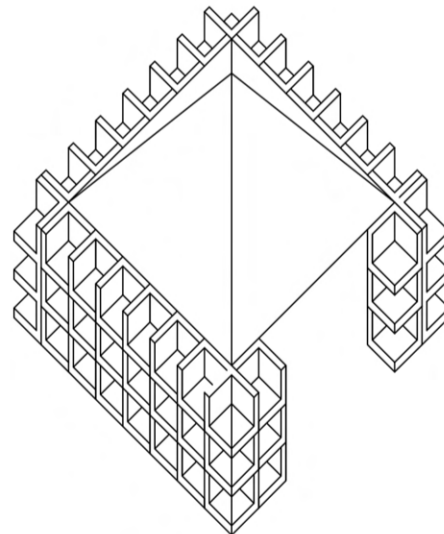
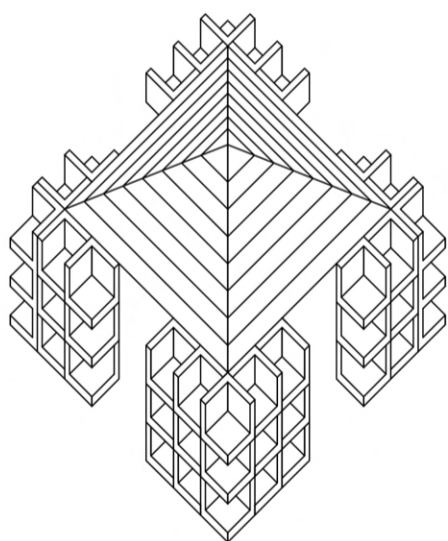

The roof went through several redesigns but eventually became more like the walls. The idea was for the shelf cells to be filled with soiled and serve as a kind of pots for plants.

Later this idea became even more pronounced when I realized I could place the pavilion partially underground, given the very steep drop on the southern bank of the river next to Gamlestadstorget.

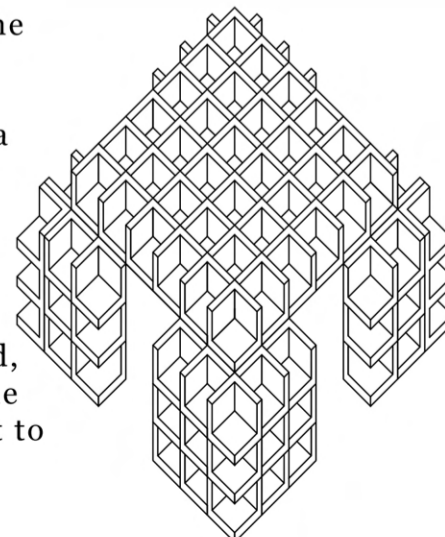
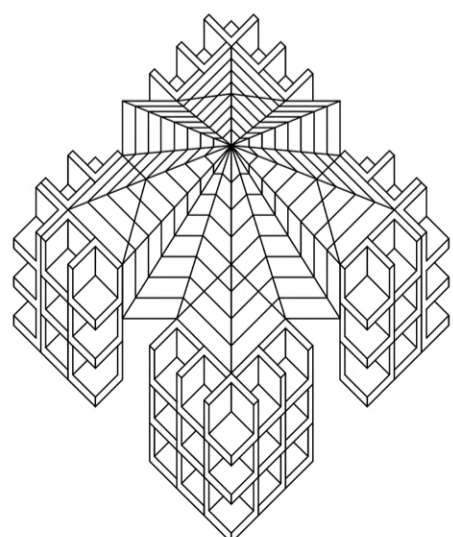

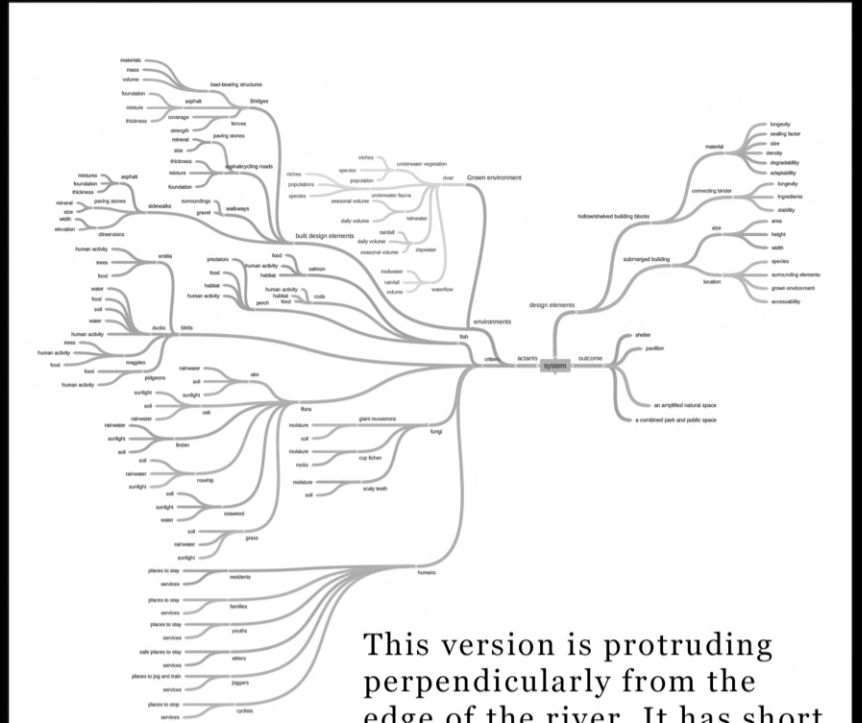
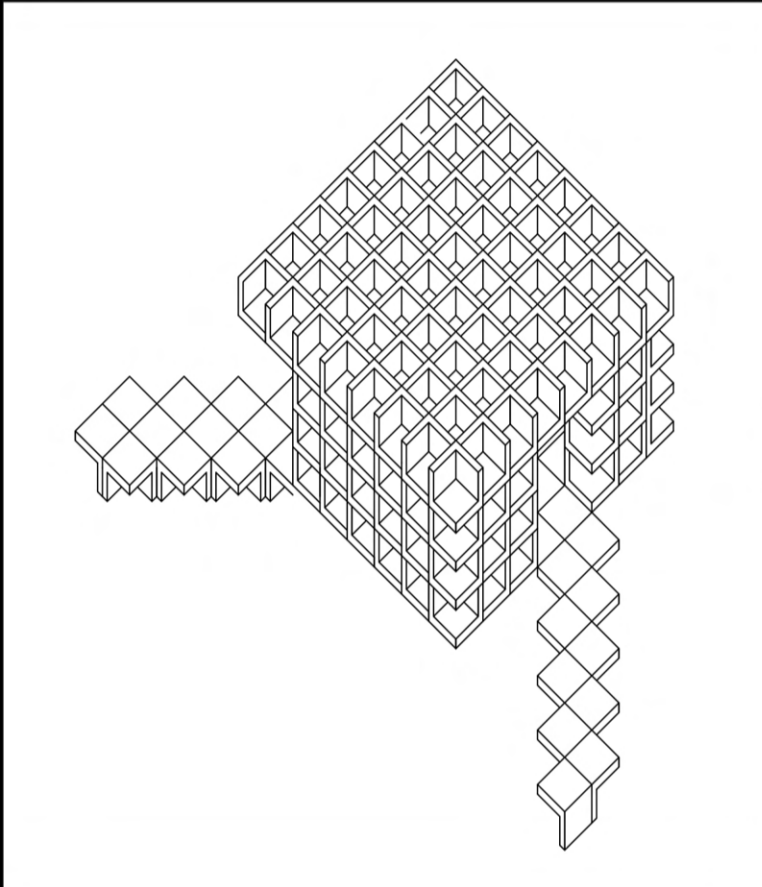
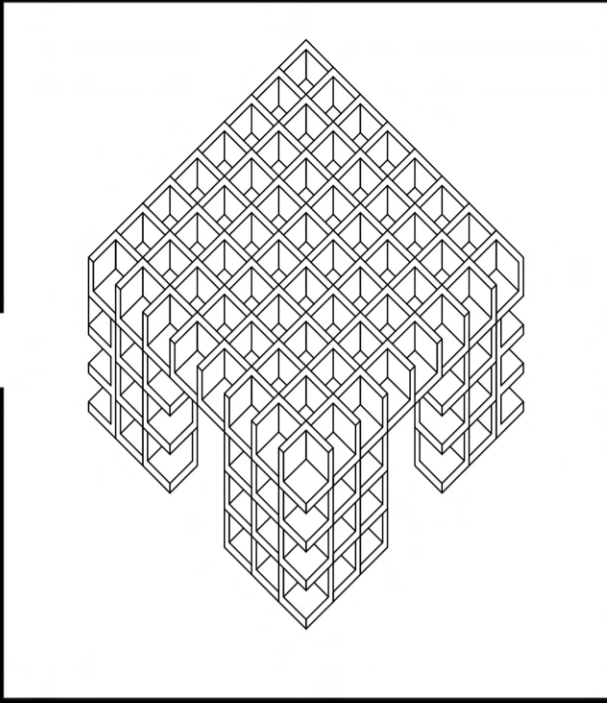

This version is protruding perpendicularly from the edge of the river. It has short piers and platforms made up of shelf cells turned "upside down", and the cells on the roof are turned in order to prevent erosion.

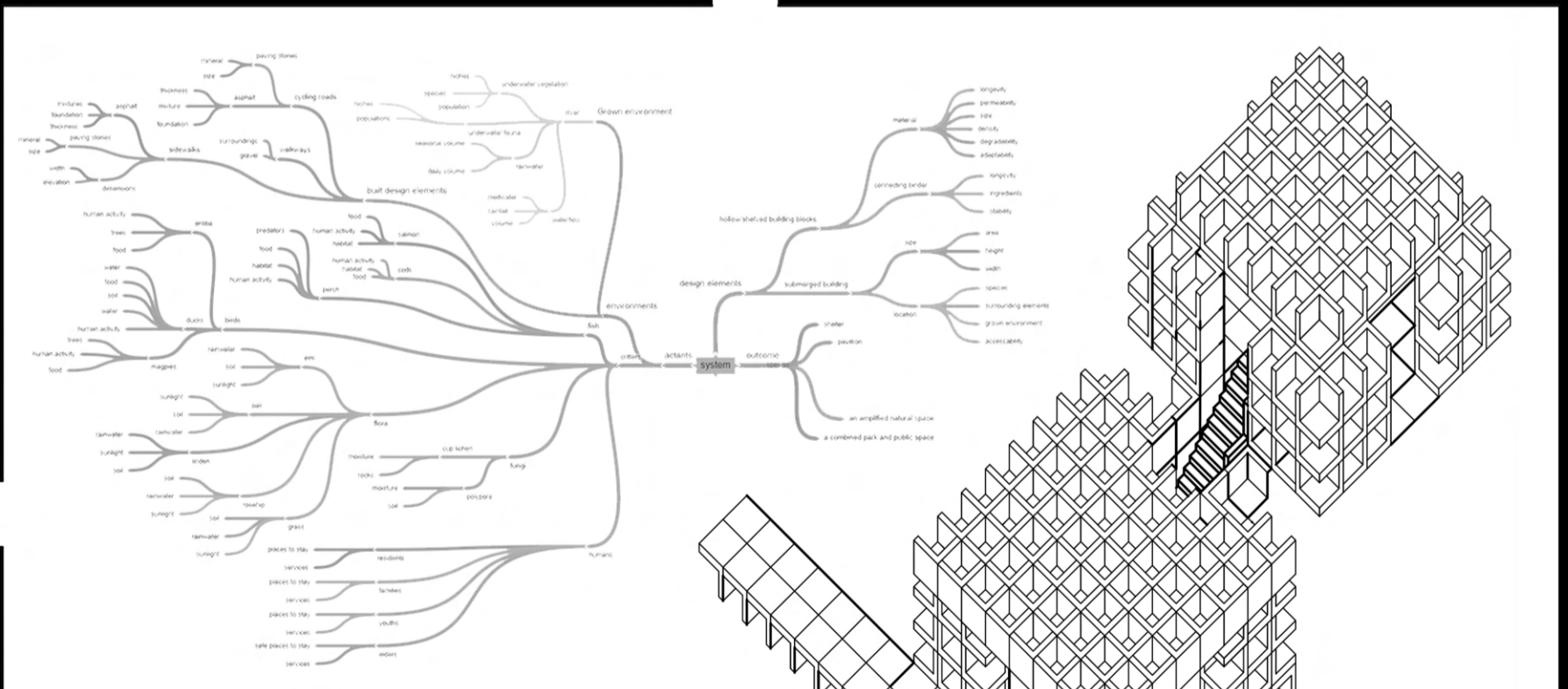
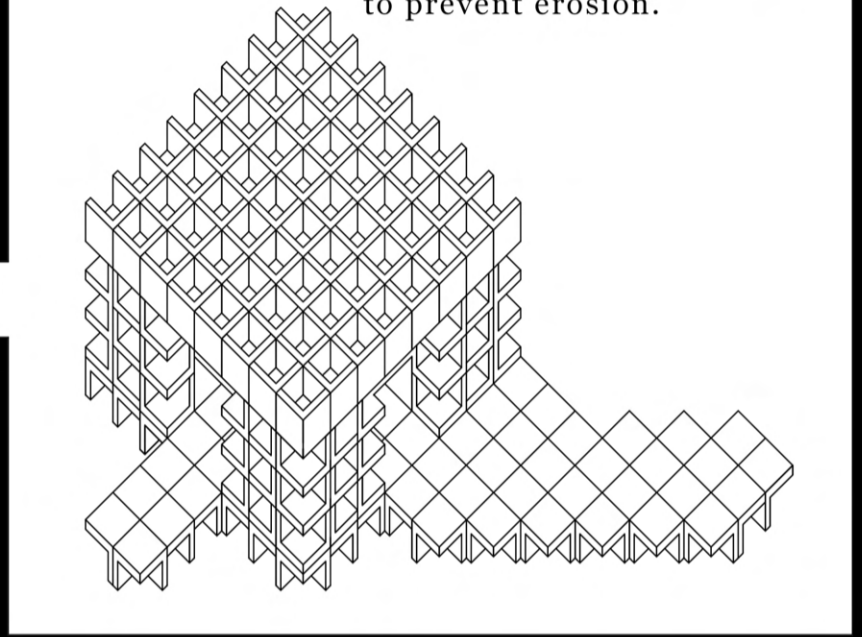

The final rendition combined the "basement" and the above-ground versions of the pavilion into two bodies connected by stairs.

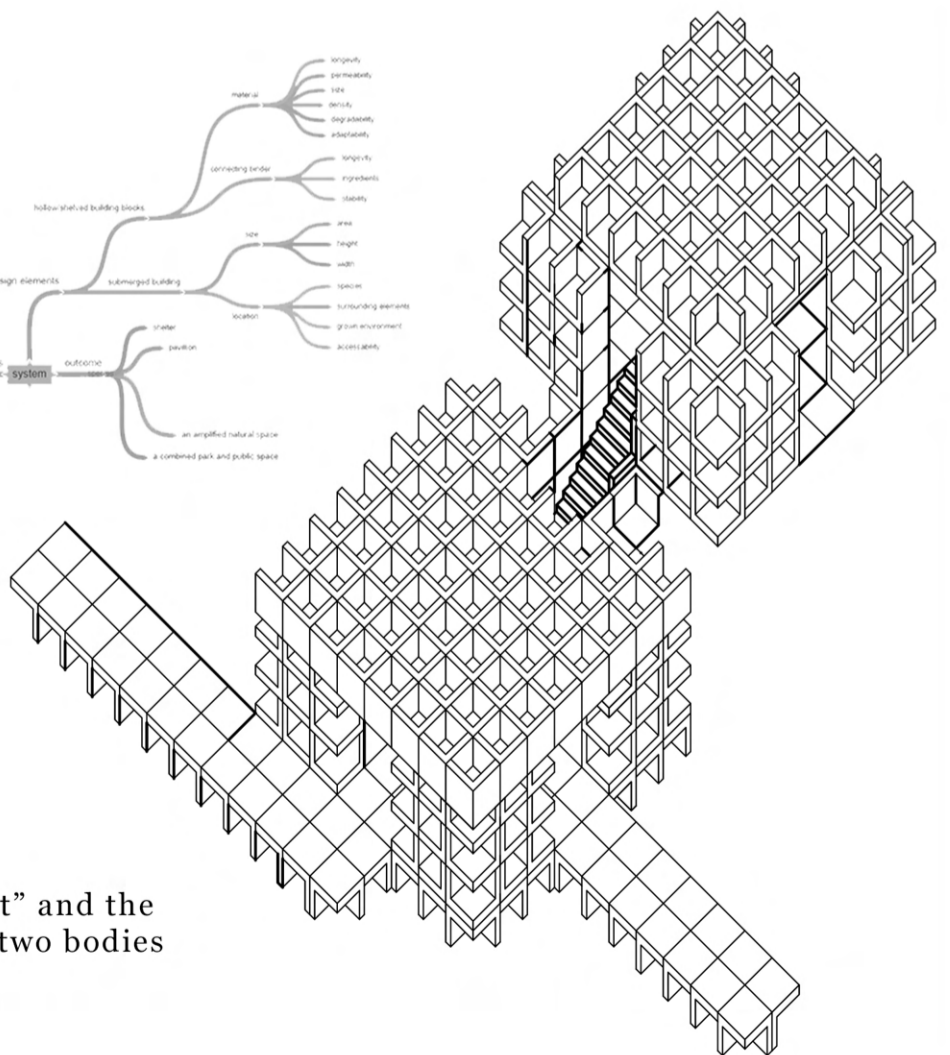

Shelf cell pavilion

Technical perspective section 1:50.

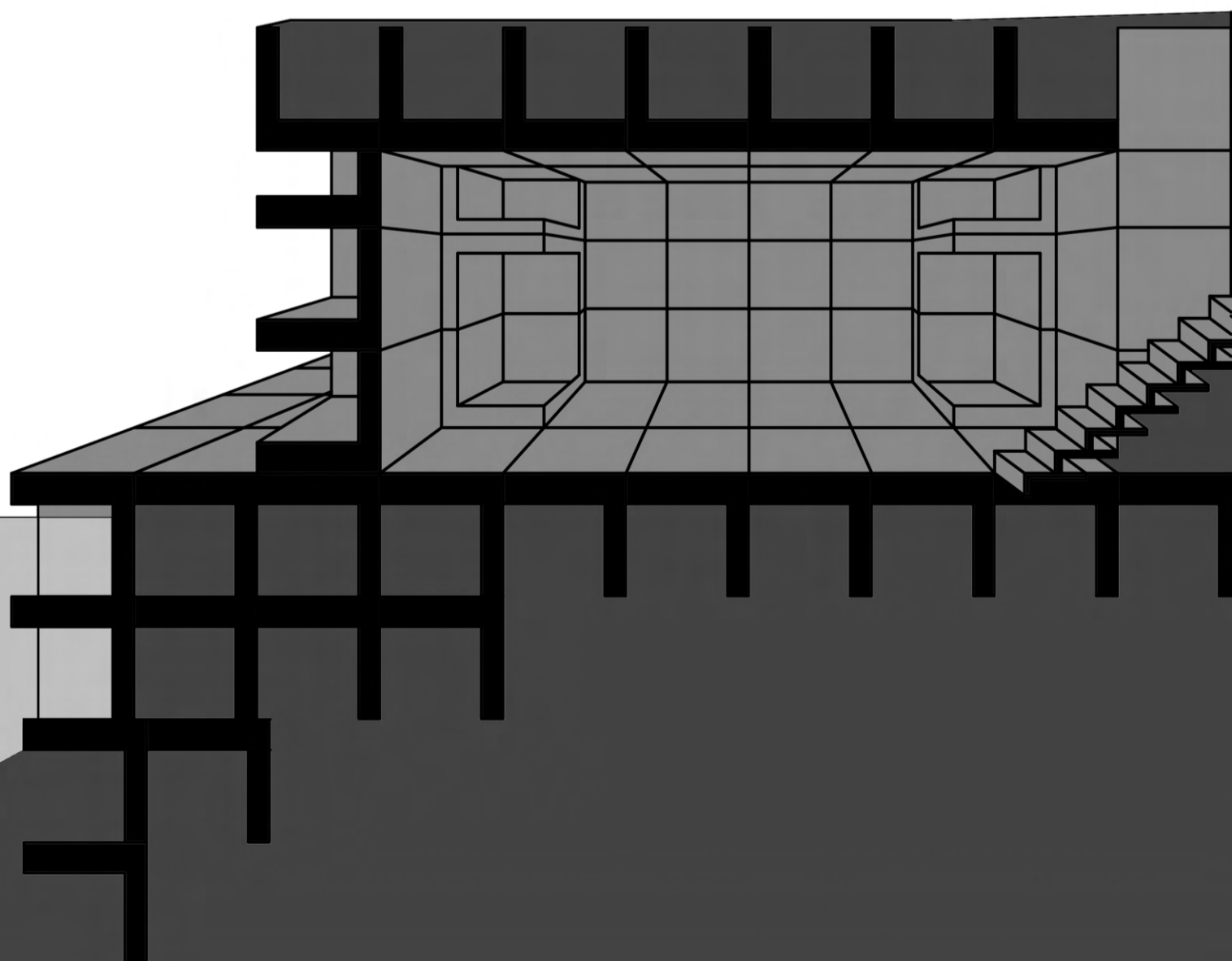

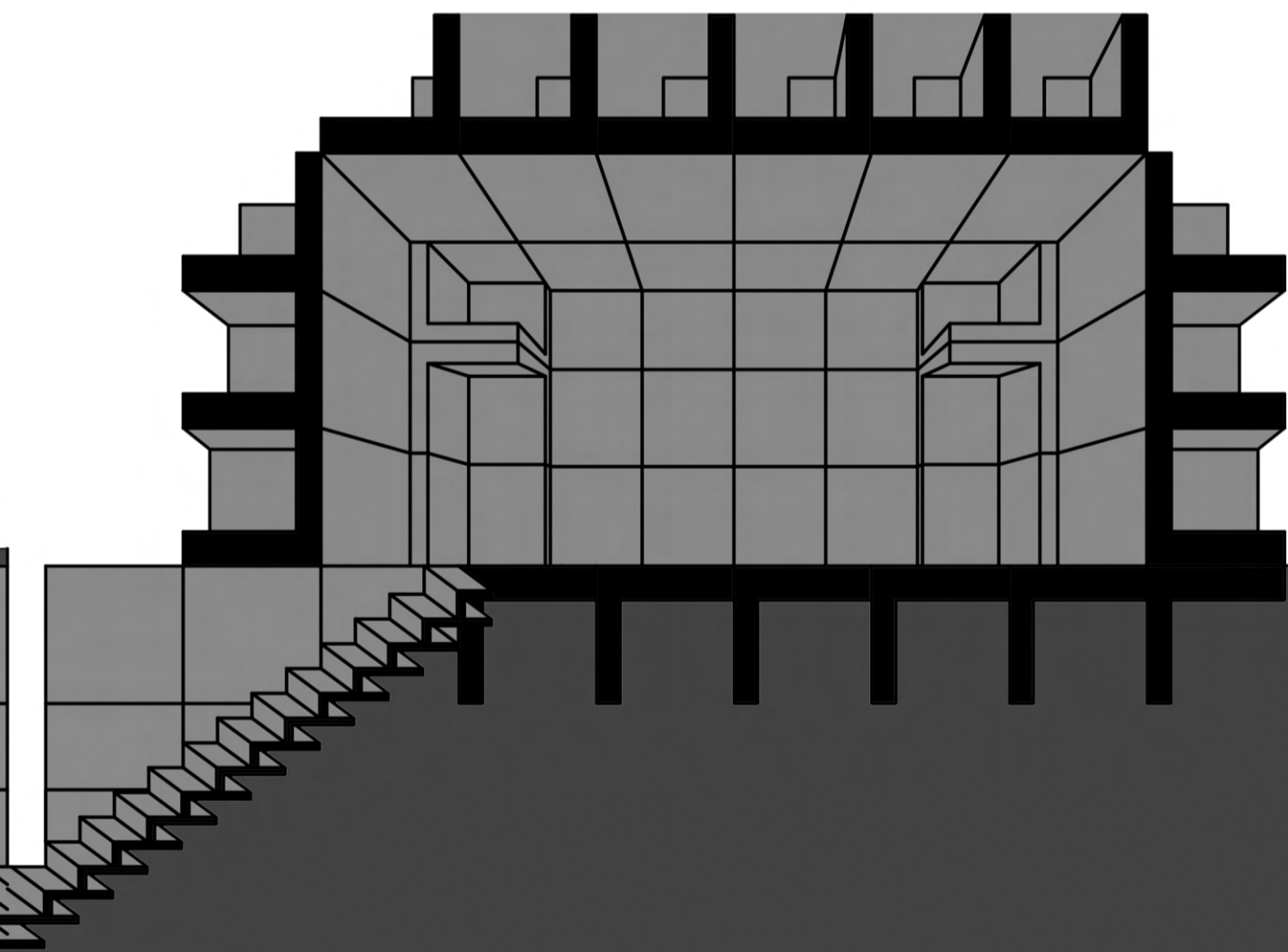

Shelf cell pavilion

Potential multiplication of the prototype along the river corridor





